

TP8-P Series Automatic Booster Pump



Power: 0.18 - 0.37 kW

50Hz

Head: Up to 30 M

Flow: Up to 35 L/min

60Hz

Head: Up to 38 M

Flow: Up to 42 L/min

Outlet: 3/4" - 1"

Applications

Ideal for pumping clean, non-volatile liquids without fibres or solids in such applications as :

1. Homes where the incoming city water supply pressure is too low
2. Portable water supply or underground
3. Irrigation
4. Washing/cleaning system

Operating Conditions

1. Ambient temperature: Max. +40°C
2. Liquid temperature: +4°C ~ +40°C
3. Suction head: Max. 8 m
4. Inlet pressure: Lower than the pressure switch OFF setting. (See Specification)

Product Features

1. Manufactured with non-corrosive rust proof materials.
2. Special design corrosive resistant pressure tank with good appearance.
3. Appropriate reliable check valve with silent operation.
4. Compact design, small size, easy installation.
5. Every pumps tested in our factory to ensure quality and reliability.
6. High performance, electricity saving motor with patented cooling construction. Build-in thermal overload protector for motor burnt out protection.

Model code

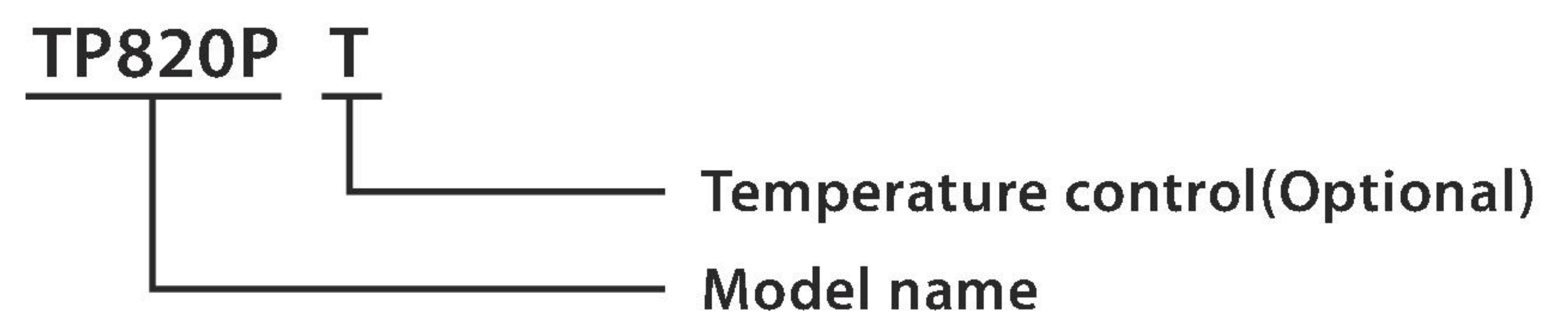

Dimensions

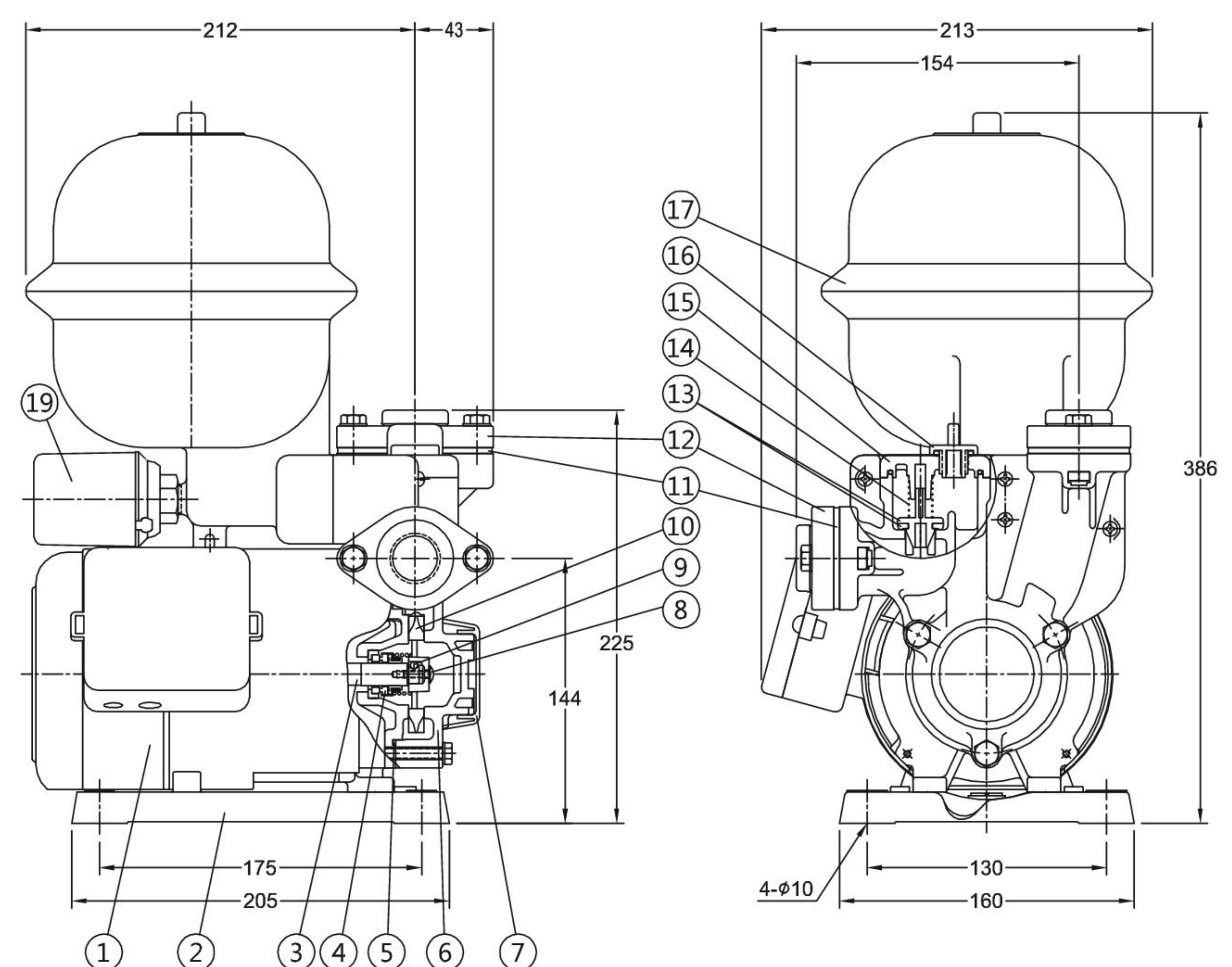

Materials

NO	Part Name	Material	NO	Part Name	Material
1	Fan cover	ABS	10	Impeller	BRASS
2	Mounted Base	ABS	11	Gasket	NBR
3	Shaft	SUS410	12	Flange	SUS304 + NYLON
4	Mechanical Seal	CERAMIC+CARBON+NBR	13	Check Valve Set	POM+NBR
5	O Ring	NBR	14	Spring	SUS304
6	Pump Casing	PPS	15	Water Cover	PPS
7	Cover	NYLON	16	Water Plug	NYLON
8	Screw	SUS304	17	Pressure Tank	PP
9	Steel Ball	SUS304	19	Pressure Switch	—

Performance curve

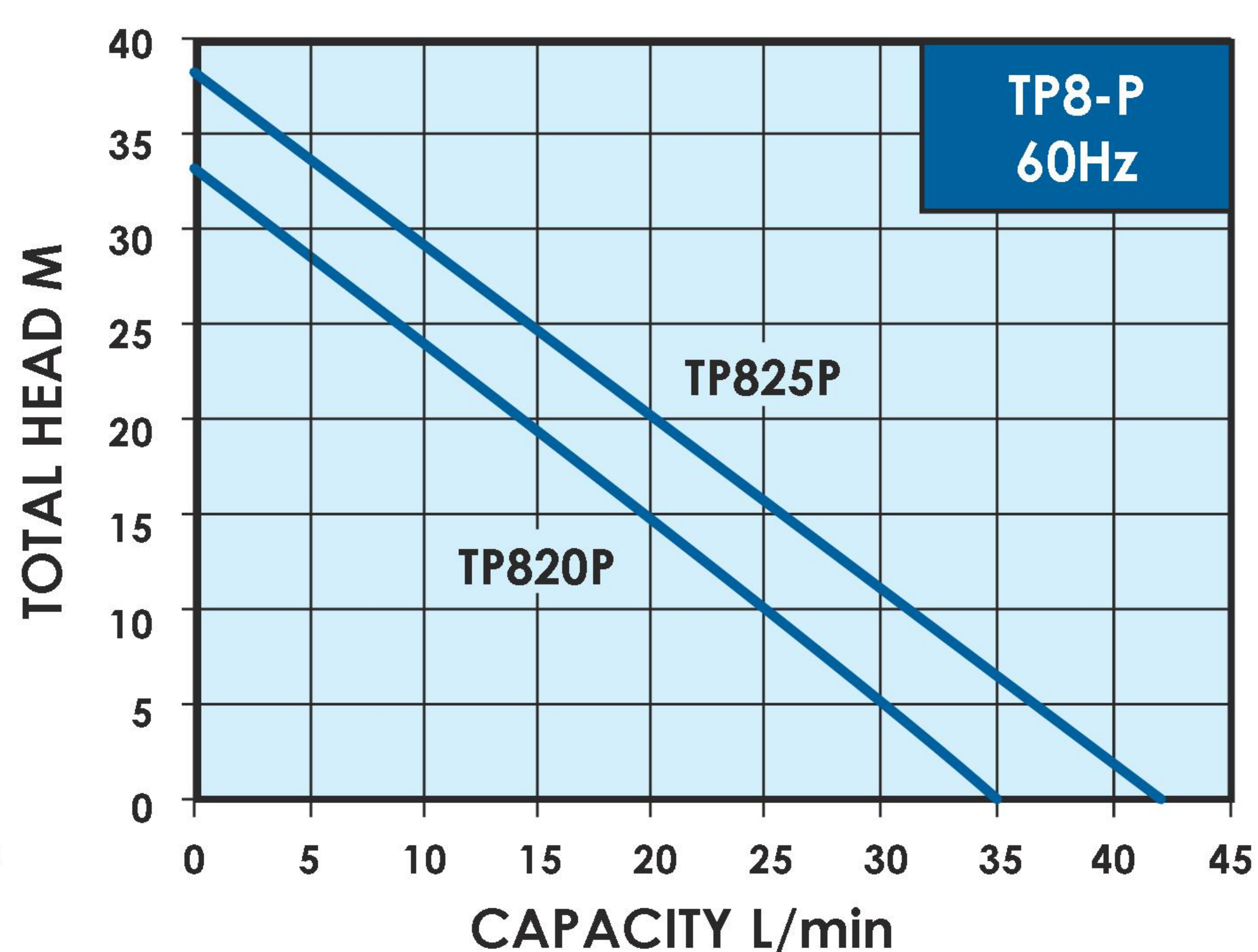
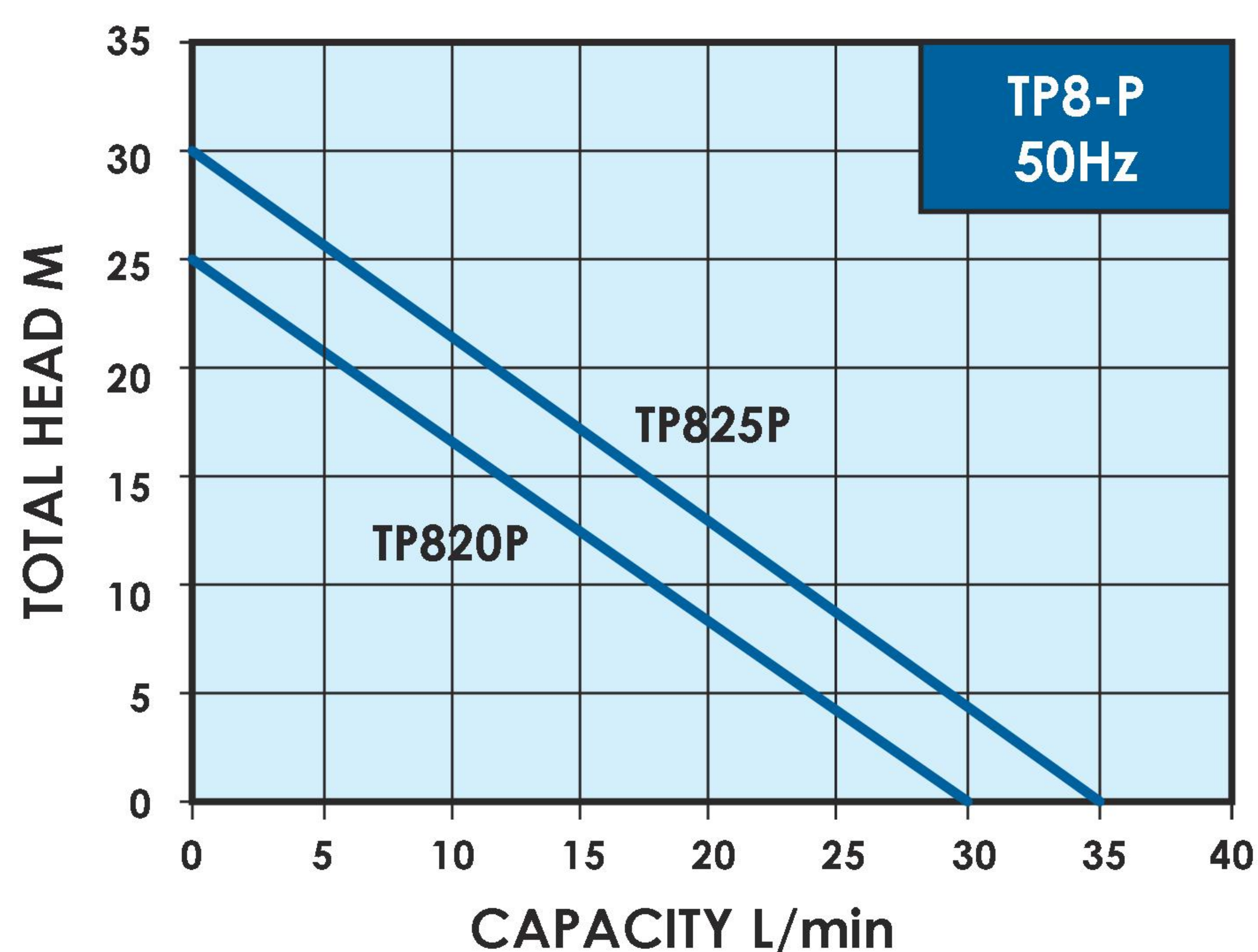

Specification, 50Hz

Model	Power (kW)	Cycle (Hz)	Phase (Ø)	Voltage (V)	Amp's (A)	Pressure Switch kg/cm ²		Pressure Tank (L)	Inlet (in.)	Outlet (in.)	H max. (m)	Q max. (L/min)	N.W. (kg)	
						ON	OFF							
TP820P(T)	0.18	50	1	200-240	1.4	0.9	1.8	1	3/4"	3/4"	25	30	6.7	32
TP825P(T)	0.37	50	1	200-240	2.7	1.8	2.8	1	1"	1"	30	35	7.6	32

Specification, 60Hz

Model	Power (kW)	Cycle (Hz)	Phase (Ø)	Voltage (V)	Amp's (A)	Pressure Switch kg/cm ²		Pressure Tank (L)	Inlet (in.)	Outlet (in.)	H max. (m)	Q max. (L/min)	N.W. (kg)	
						ON	OFF							
TP820P(T)	0.18	60	1	110/220	3.2/1.6	1.2	2.4	1	3/4"	3/4"	34	35	6.7	32
TP825P(T)	0.37	60	1	110/220	5.2/2.6	2.0	3.0	1	1"	1"	38	42	7.6	32