

Multistage Centrifugal Pump

HM Series

- Pressure boosting for Agriculture irrigation, Household & Domestic application
- Circulate water system in light industry i.e. Air conditioning system, booster pump, Heat dissipation system for machinery.



Application

- Higher power driving motor is required when transferring liquid with higher density than water's
- Pump casing made with high-quality materials, strong, durable with flange design and threaded design
- Low noise operation and constant water pressure.
- Bearings are water and dustproof.
- Built-in cooling fan extent motor's lifespan.
- Compact design, small size, easy installation and easy to maintenances.
- Ground wire for best protection

Model information

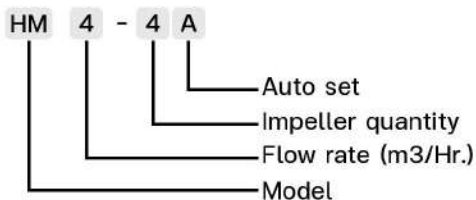

Feature



Genuine Copper coil with Thermal Overload Protection

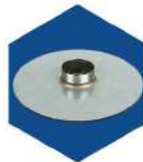

Stainless impeller : closed impeller , no rust, Provides high water flow and high water pressure .



Rotor made of AISI304 corrosion resistant



Mechanical seal Ceramic-Carbon, Prevents leakage, capable of withstanding pressure, heat-resistant.

Model analysis

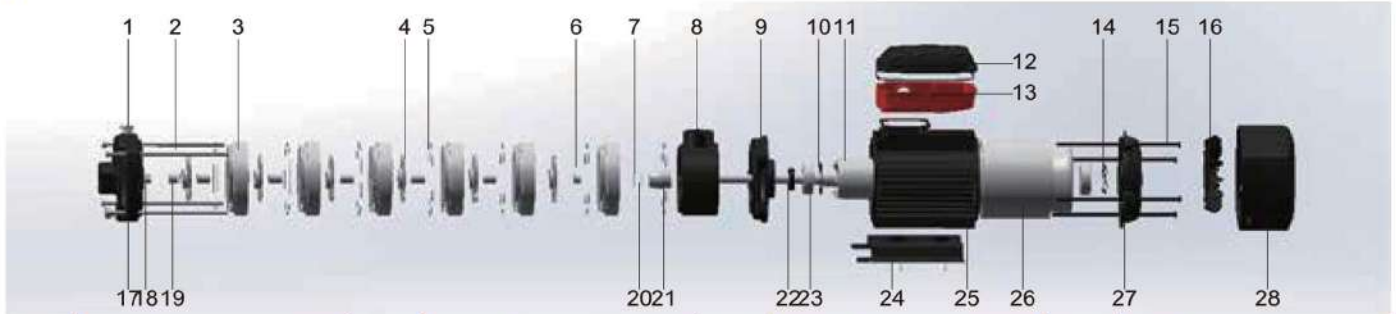

NO.	Component	NO.	Component	NO.	Component	NO.	Component
1	Screw plug	8	Pump body	15	Hexagon head bolt	22	Skeleton oil seal
2	Hexagon socket bolt	9	Front cover	16	Fan	23	Bearing
3	Pilot fluid	10	Axle ring	17	Pump cover	24	Bottom plate
4	Impeller	11	Rotor	18	Self-locking nuts	25	Base
5	Gasket	12	Terminal box cover	19	Shaft cover	26	Stator
6	Shaft sleeve	13	Terminal box holder	20	Flat gasket	27	Motor cover
7	Shaft ring	14	Wave gasket	21	Mechanical seal	28	Fan cover

Specifications

Model	HM2-5	HM4-4	HM4-5	HM4-6
Power (W)	550 (0.75)	750 (1HP)	1000 (1.3HP)	1300 (1.7HP)
Cycle (Hz)	50	50	50	50
Voltage (V)	220-230	220-230	220-230	220-230
Amp (A)	4.1	5.0	5.5	5.8
Max Head (M)	50	40	50	60
Max Flow rate (LPM)	67	100	100	100
Pressure (Kg/cm ²)	2.0-3.5	2.0-3.5	2.5-4.5	2.5-5.0
Inlet (in.)	1	1 ¼	1 ¼	1 ¼
Outlet (in.)	1	1	1	1
N.W. (kg)	11.2	12.5	14	14.5
G.W. (kg)	12.2	13.5	15	15.5
Packaging size (mm)	437*220*275	419*220*280	455*220*275	470*220*275

Performance curves

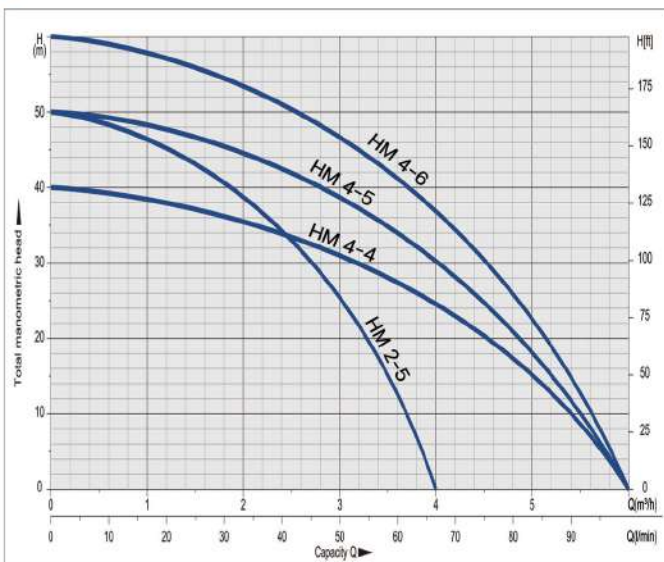

Installation method and size

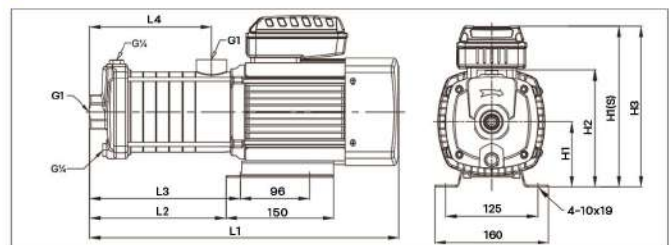

Model	L1	L2	L3	L4	H1(S)	H3	H1	H2
HM 2-5	390	180	200	150	205	190	75	147
HM 4-4	370	160	180	130	205	190	75	147
HM 4-5	400	170	190	150	220	210	90	165
HM 4-6	420	190	210	170	220	210	90	165

Executive agent :