

Submersible Drainage Pump

LA Series

- Used for pumping water from wells, tanks, and reservoirs
- For Agriculture irrigation and aquaculture farms, sprinkler.
- Drain flood water



Impeller Type

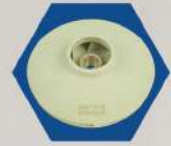

PPO Impeller



Aluminum Impeller
(LA753 Only)

FREE Outlet 1.5 Inch.
(LA750/F Only)

Application

- Aluminum pump casing, light weigh, compact design, easy for installation, convenient carrying handle.
- Quiet operation and constant pressure.
- Double mechanical seal, O-ring and Oil seal.
- Bearings are water and dustproof.
- Ground wire for best protection.

Model information

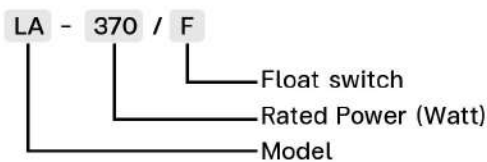

Feature



Genuine Copper coil with Thermal Overload Protection

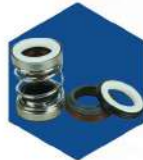

Mechanical seal Ceramic-Ceramic, Prevents leakage, capable of withstanding pressure, heat-resistant.



Suction strainer: made with Stainless steel prevents debris from clogging the pump.



Float switch as a sensor for water level measurement, make pump operation to the desired water level set by the user.

Specifications

Model	LA370 / F	LA550	LA750 / F	LA753
Power (W)	370	550	750 (1HP)	750 (1HP)
Cycle (Hz)	50	50	50	50
Voltage (V)	220-230	220-230	220-230	220-230
Amp (A)	3.12	4.76	5.2	5.2
Max Head (M)	19	13.5	19.5	9.5
Max Flow rate (LPM)	150	230	265	583
Outlet (in.)	1	1.5	2	3
N.W. (kg)	8.5	12.5	12.5	15
G.W. (kg)	9.5	13.5	13.5	16
Packaging size (mm)	405*230*195	430*250*205	430*250*205	470*290*230

Installation method and size

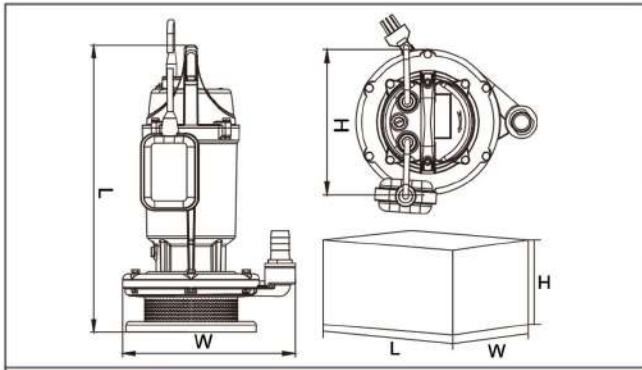

รุ่นสินค้า	Weight (kg)	L (mm)	W (mm)	H (mm)
LA370 / F	9.5	405	230	195
LA550	13.5	430	250	205
LA750 / F	13.5	430	250	205
LA753	16	470	290	230

Performance curves

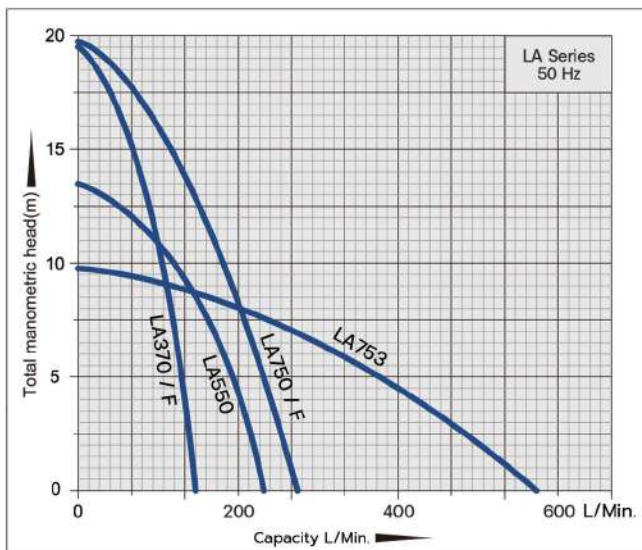

Model analysis

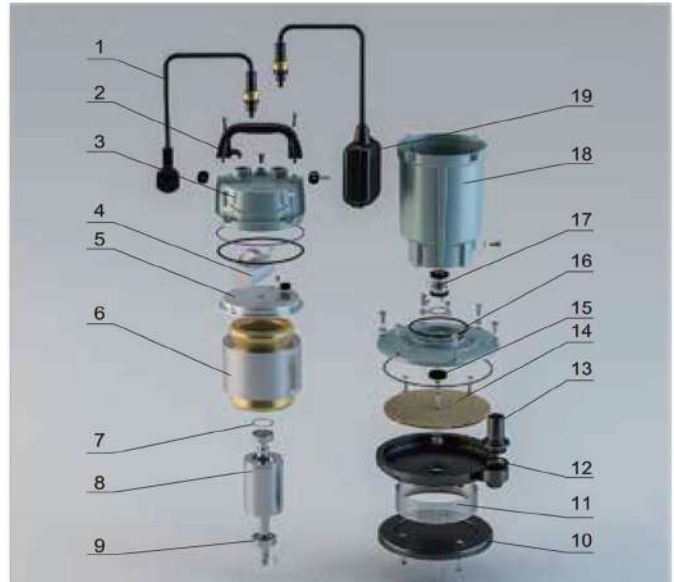

01	Cable	11	Filter
02	Handle	12	Pump body
03	Top cover	13	Inlet connector
04	Capacitor	14	Impeller
05	Upper bearing seal	15	Oil seal
06	Stator	16	O-Ring
07	Wave washer	17	Mechanical seal
08	Rotor	18	Pump base
09	Bearings	19	Float switch
10	Support		

Executive agent :